

**A**  
Index

| Pos. | Ident No.    | Description                       |
|------|--------------|-----------------------------------|
| □    | 549000 40500 | <b>SET OF SEALS *</b>             |
| 4    | 500101 40500 | PUMP BODY                         |
| 6    | 020000 40500 | ROTOR                             |
| 7    | 900585 00000 | <b>VANES (3)</b>                  |
| 8    | 000700 40500 | LID                               |
| 9    | 945618 00000 | THREADED PIN                      |
| 14   | 945373 00000 | SOCKET HEAD SCREW                 |
| 15   | 945374 00000 | SOCKET HEAD SCREW                 |
| 16   | 947628 01000 | STRAIGHT PIN                      |
| 17   | 945801 01000 | THREADED PIN                      |
| 18   | 901807 00000 | SCREW                             |
| 19   | 949203 00000 | TOOTHED SPRING WASHER             |
| 20   | 016800 05000 | CLAMPING DISC                     |
| 21   | 537500 10700 | VALVE                             |
| 22   | 028501 10700 | VALVE BOLT                        |
| 23   | 928600 70000 | PRESSURE SPRING                   |
| 24   | 033901 10700 | VALVE PLATE                       |
| 28   | 946917 00000 | STUD                              |
| 29   | 917107 00000 | CUP SPRING                        |
| 30   | 947105 00000 | HEX.NUT                           |
| 32   | 951228 02000 | LOCKING SCREW                     |
| 36   | 068101 40500 | FLANGES                           |
| 37   | 945634 00000 | THREADED PIN                      |
| 38   | 741310 60000 | RUBBER BUFFER                     |
| 44   | 867800 99559 | FLOAT                             |
| 45   | 005001 40300 | SIEVE                             |
| 47   | 727503 99628 | BLOW-OFF VALVE                    |
| 58   | 965414 00000 | <b>OIL SEPARATING ELEMENT (1)</b> |
| 59   | 016802 40300 | CLAMPING DISC                     |
| 60   | 921500 50000 | HANDLE                            |
| 63   | 003700 40500 | COVER                             |
| 66   | 945320 00000 | SOCKET HEAD SCREW                 |
| 67   | 953103 00000 | NOZZLE                            |
| 72   | 005000 40500 | METAL FILTER                      |
| 74   | 945321 00000 | SOCKET HEAD SCREW                 |
| 82   | 960200 40500 | COOLER                            |
| 83   | 917800 40500 | RETAINING RING                    |
| 84   | 960700 40500 | VENTILATOR HOOD                   |
| 85   | 946308 00000 | CYLINDER SCREW                    |
| 86   | 948750 00000 | BLIND RIVET                       |
| 89   | 912317 00000 | CONNECTING SCREW                  |
| 90   | 948407 00000 | HOLLOW SCREW                      |
| 94   | 012203 40500 | PIPE                              |
| 95   | 012204 40500 | PIPE                              |
| 101  | 002401 40500 | HOUSING FOR OIL SEPARATOR         |
| 103  | 907309 00000 | OIL SIGHT GLASS                   |

**A**  
Index

| Pos. | Ident No.    | Description                          |
|------|--------------|--------------------------------------|
| 105  | 951219 00000 | LOCKING SCREW                        |
| 107  | 951221 00000 | LOCKING SCREW                        |
| 110  | 916800 10000 | COVER                                |
| 114  | 912318 00000 | CONNECTING SCREW                     |
| 115  | 003300 10700 | NOZZLE                               |
| 116  | 912300 00000 | CONNECTING SCREW                     |
| 118  | 009400 19000 | HOLLOW HOLDING SCREW                 |
| 119  | 012200 40300 | PIPE                                 |
| 197  | 741103 99683 | OIL LEVEL CONTROL - <b>OPTIONAL</b>  |
| 201  | 007801 40500 | SCREWED FLANGE - STANDARD            |
| 202  | 007802 40500 | SCREWED FLANGE 90° - <b>OPTIONAL</b> |
| 203  | 537506 99633 | NON RETURN VALVE                     |

\* **COMPLETE SET OF SEALS** - 549000 40500

POS.: 11, 12, 25, 26, 33, 42, 55, 62, 65, 73, 91, 104, 106, 108, 117, 208

OPTIONAL

**U 4.40 / 09**

Special design - with gas ballast valve

Items different from standard appliance see appendix (back of drawing)

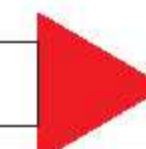

**D**  
Index**U 4.70**

| Pos. | Ident No.    | Description                               |
|------|--------------|---|
| □    | 549000 26100 | COMPLETE SET OF SEALS <sup>1)</sup>       |
| 1    | 000101 26100 | PUMP BODY                                 |
| 3    | 020000 26100 | ROTOR                                     |
| 5    | 900511 00000 | ROTOR VANE IN PLASTIC (3x) <sup>2)</sup>  |
| 7    | 917609 00000 | GASKET                                    |
| 8    | 917501 00000 | DISTANCE DISC                             |
| 9    | 906622 00000 | BEARING                                   |
| 10   | 906560 00000 | SHAFT SEALING RING                        |
| 12   | 912820 00000 | CAP                                       |
| 15   | 000800 26200 | SIDE SHIELD                               |
| 16   | 000700 26200 | SIDE SHIELD                               |
| 17   | 912871 00000 | LOCKING SCREW                             |
| 18   | 902000 10600 | COUPLING PUMP                             |
| 21   | 945320 00000 | HEX HEAD SCREW                            |
| 22   | 948742 00000 | GROOVED PIN                               |
| 24   | 947732 00000 | KEY                                       |
| 28   | 952008 00000 | LOCATING PEG                              |
| 29   | 951705 00000 | SPRING DISC                               |
| 30   | 902300 26200 | FAN                                       |
| 31   | 947713 00000 | KEY                                       |
| 32   | 901808 00000 | SHAFT END BOLD                            |
| 33   | 947507 00000 | WASHER                                    |
| 34   | 028501 10700 | VALVE BOLT                                |
| 35   | 928600 70000 | PRESSURE SPRING                           |
| 36   | 033901 10700 | VALVE PLATE                               |
| 41   | 007800 26200 | FLANGE                                    |
| 42   | 533900 26200 | VALVE PLATE                               |
| 44   | 005000 26200 | SIEVE                                     |
| 46   | 948219 02000 | LOCKING RING                              |
| 49   | 928602 60000 | PRESSURE SPRING                           |
| 52   | 945325 00000 | SOCKET HEAD SCREW                         |
| 54   | 951602 00000 | RING UNIT                                 |
| 55   | 945814 00000 | THREADED PIN                              |
| 57   | 951228 02000 | LOCKING SCREW                             |
| 61   | 002404 26200 | HOUSING FOR OIL SEPARATION                |
| 63   | 509400 26200 | HOLLOW HOLDING SCREW                      |
| 64   | 001702 26200 | OIL TANK COVER                            |
| 65   | 951221 00100 | LOCKING SCREW                             |
| 67   | 003701 26200 | COVER                                     |
| 69   | 951005 02000 | STUD                                      |
| 70   | 948504 00000 | SPRING WASHER                             |
| 71   | 947104 00000 | HEX.NUT                                   |
| 74   | 305800 02000 | COUPLING NUT                              |
| 76   | 727502 99628 | BLOW-OFF VALVE                            |
| 83   | 965416 00000 | OIL SEPARATING ELEMENT (1x) <sup>2)</sup> |
| 89   | 921500 50000 | HANDLE                                    |
| 90   | 013300 26200 | METAL FILTER                              |
| 91   | 945305 00000 | SOCKET HEAD SCREW                         |
| 93   | 945226 00000 | HEX. HEAD SCREW                           |
| 94   | 867800 99559 | FLOAT                                     |
| 95   | 003300 10700 | NOZZLE                                    |
| 97   | 912300 00000 | CONNECTING SCREW                          |
| 98   | 912871 00000 | LOCKING SCREW                             |
| 101  | 506000 26200 | COARSE SEPARATOR                          |
| 104  | 008001 26200 | SCREEN                                    |
| 112  | 003703 26200 | COVER                                     |
| 119  | 907309 00000 | OIL SIGHT GLASS                           |
| 120  | 916800 10000 | COVER                                     |
| 130  | 945387 00000 | SOCKET HEAD SCREW                         |
| 131  | 945319 00000 | SOCKET HEAD SCREW                         |

**D**  
Index**U 4.70**

| Pos. | Ident No.    | Description                 |
|------|--------------|-----------------------------|
| 132  | 945323 00000 | INNENSECHSKANTSCHRAUBE      |
| 133  | 945319 00000 | INNENSECHSKANTSCHRAUBE      |
| 134  | 945324 00000 | INNENSECHSKANTSCHRAUBE      |
| 135  | 951220 00100 | VERSCHLUSSSCHRAUBE          |
| 141  | 012211 26200 | LEITUNG                     |
| 143  | 012202 26200 | LEITUNG                     |
| 146  | 912305 00000 | ANSCHLUSS-SCHRAUBE          |
| 148  | 948401 00000 | HOHLSCHRAUBE                |
| 150  | 012209 26200 | LEITUNG                     |
| 151  | 012205 26200 | LEITUNG                     |
| 152  | 009400 19000 | KUGELSTUECKSCHRAUBE         |
| 154  | 012900 19000 | VERSCHLUSS-SCHRAUBE         |
| 156  | 912306 00000 | ANSCHLUSSSCHRAUBE           |
| 157  | 960202 26200 | KUEHLER                     |
| 158  | 012210 26200 | LEITUNG                     |
| 159  | 948402 00000 | HOHLSCHRAUBE                |
| 181  | 018300 26200 | ABDECKHAUBE                 |
| 183  | 922400 60000 | SCHUTZGITTER                |
| 186  | 568001 10700 | ZWISCHENSTUECK              |
| 187  | 568100 10700 | STUETZE KOMPL.              |
| 188  | 949408 00000 | U-SCHEIBE                   |
| 190  | 001800 20000 | WELLENABSCHLUSSSCHRAUBE     |
| 192  | 945318 00000 | INNENSECHSKANTSCHRAUBE      |
| 193  | 949203 00000 | ZAHNSCHEIBE                 |
| 197  | 741310 60000 | GUMMIPUFFER                 |
| 210  | 003301 30000 | DUESE                       |
| 214  | 950700 10000 | LUESTERKLEMME               |
| 215  | 946304 00000 | SCHRAUBE                    |
| 216  | 943400 90000 | TEMPERATURFUEHLER           |
| 241  | 902100 10600 | MOTORKUPPLUNGSHAELFTE Ø24MM |
| 242  | 902101 10600 | MOTORKUPPLUNGSHAELFTE Ø28MM |
| 245  | 945117 00000 | SECHSKANTSCHRAUBE           |
| 246  | 948507 00000 | FEDERRING                   |
| 248  | 902200 10600 | KUPPLUNGSRING               |
| 250  | 902100 26100 | MOTORKUPPLUNG (US)          |
| 251  | 037900 26200 | ZWISCHENFLANSCH (US)        |
| 254  | 945232 00000 | SECHSKANTSCHRAUBE (US)      |



<sup>1)</sup> Set of seals - 54900026100 - Pos.: 25, 26, 37, 38, 47, 58, 77, 79, 80, 121, 129, 149, 153, 160  
<sup>2)</sup> necessary order quantity / maintenance

OPTIONAL

|                    |     |  |
|--------------------|-----|--|
| <b>U 4.70 SA</b>   |     | Special design – without cooling apparatus                               |
| <b>U 4.70 SA/K</b> | -25 | Special design – with oil-to-water heat exchanger                        |
|                    | -51 | Special design – with oil bath heating, level transmitter and heat valve |
|                    | -54 | Special design – with additional oil draining bore hole                  |
| <b>U 4.70 F</b>    |     | Special design – without cooling apparatus                               |
| <b>U 4.70 F/K</b>  | -25 | Special design – with oil-to-water heat exchanger                        |
|                    | -51 | Special design – with oil bath heating, level transmitter and heat valve |

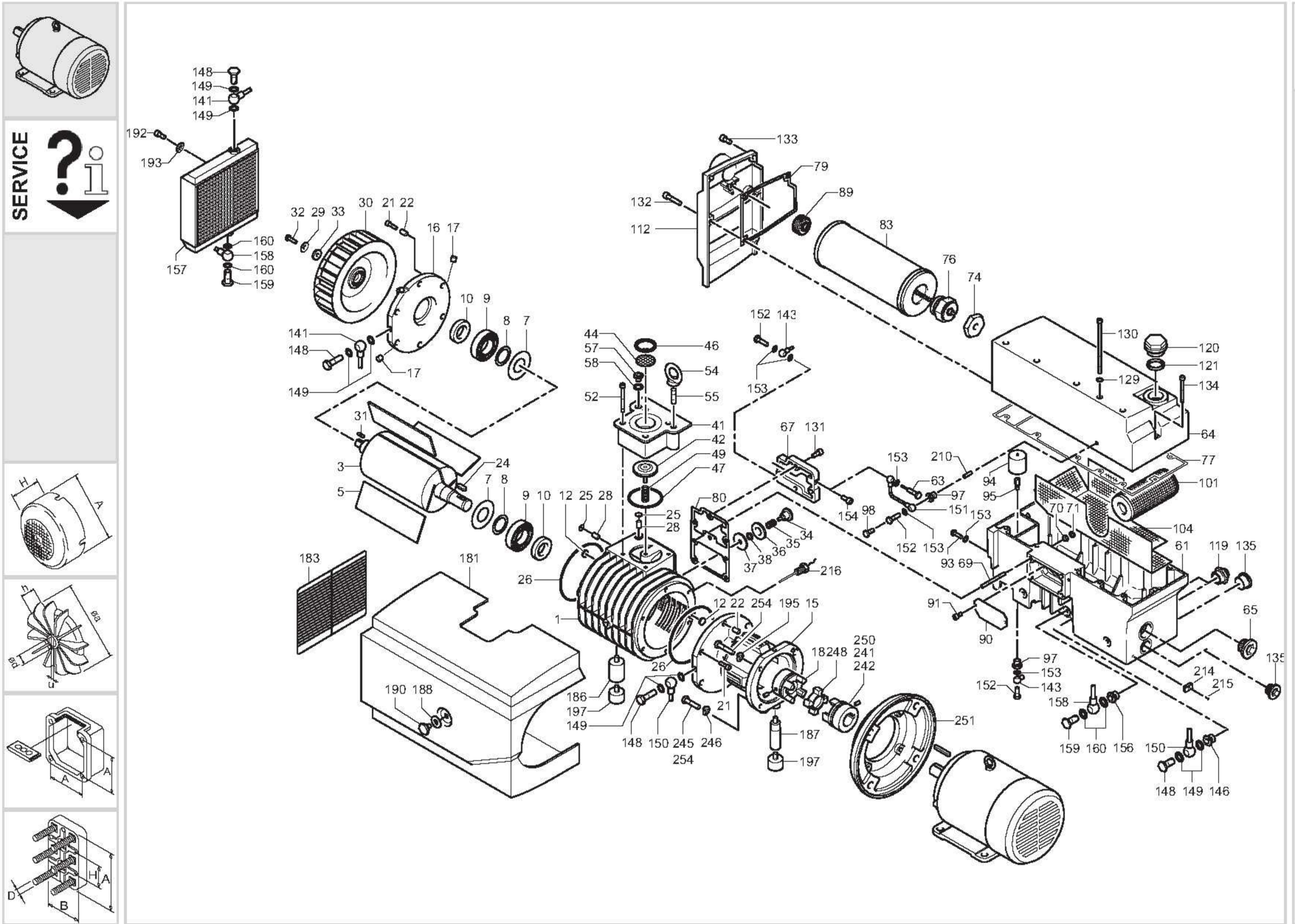

Items different from standard appliance see appendix (back of drawing) 





standard

U 4.70 F/K  
U 4.70 SA/K

optional  
en option  
opcionale  
opcional

| optional<br>en option<br>optionale<br>opcional  | Variante(n)<br>Modifications<br>Variantes | Pos   |  |  | Bestell Nr.<br>Ident No.<br>No. Identification<br>No. Identificazione<br>No. De pedido   | Beschreibung / Description / Designation / Designazione / Descripcion  |
|--|---|---|---|---|--|--|
| U 4.70 SA/XX<br><br>U 4.70 F/XX  | U 4.70 SA<br>U 4.70 F                     | 135<br>141<br>144<br>156<br>157<br>158<br>159<br>160<br>192<br>193                                      | X   | X<br>X<br>X<br>X<br>X<br>X<br>X<br>X<br>X   | 012203 26200   | LEITUNG / PIPE / TUYAU / CONDOTTO / CONDUCTO   |
|  | U 4.70 SA/K - 25<br>U 4.70 F/K - 25       | 29<br>30<br>31<br>32<br>33<br>141<br>150<br>155<br>157<br>158<br>181<br>192<br>193<br>211<br>212<br>213 | X<br>X<br>X<br>X<br>X<br>X<br>X<br>X<br>X<br>X<br>X<br>X<br>X<br>X                | X<br>X<br>X<br>X<br>X<br>X<br>X<br>X<br>X<br>X<br>X<br>X<br>X<br>X<br>X           | 012214 26200<br>012213 26200<br>948420 00000<br>960204 26200<br>012212 26200<br>018301 26200<br><br>300000 02300<br>739213 01000<br>948024 00000 | LEITUNG / PIPE / TUYAU / CONDOTTO / CONDUCTO<br>LEITUNG / PIPE / TUYAU / CONDOTTO / CONDUCTO<br>HOHLSCHRAUBE / HOLLOW SCREW / VIS CREUSE / VITE ESAGONALE / TORNILLO HUECO<br>KUEHLER / COOLER / REFROIDISSEUR / RAFFREDDATORE / REFRIGERADOR<br>LEITUNG / PIPE / TUYAU / CONDOTTO / CONDUCTO<br>HAUBE / PROTECTING HOOD / CARTER PROTECTEUR / CARTER DI PROTEZIONE / SOMBRERETE<br><br>WINKEL / ELBOW / COUDES / GOMITO / ÁNGULO<br>SCHLAUCHSTUTZEN / HOSE CONNECTOR / CONNEXION TUYAU / ATTACCO TUBO / TUBULADURA DE MANGUERA<br>KUPFERRING / SEALING RING / JOINT / ANNELLO / ANILLO DE COBRE   |
|  | U 4.70 SA/K - 51<br>U 4.70 F/K - 51       | 61<br>65<br>341<br><br>342<br>343<br>344<br>345<br>346<br>347   | X<br>X<br>X<br>X<br>X<br>X<br>X<br>X  | X<br>X  | 002406 26200<br><br>960203 26200<br>943400 70000<br>741103 99682<br>948086 00000<br>948029 00000<br>912314 00000                                 | ÖLABSCHEIDERGEHÄUSE / HOUSING FOR OIL SEPARATION / CARCASSE POUR SEPARATION D'HUILLE /<br>CARCASSA SEPARATORE OLIO / CARCASA SEPARADORA DE ACEITE<br>ROHRHEIZKÖRPER / PIPE HEATER / CORPS DE CHAUFFE / SCALDIGLIA / CALEFACTOR TUBULAR<br>TEMPERATUR-WÄCHTER / THERMOSTAT / THERMOSTAT / INTERRUTTORE TERMICO / TERMOSTATO<br>NIVEAUGEBER / LEVEL TRANSMITTER / CAPTEUR DE NIVEAU / INDICATORE DI LIVELLO / CODIFICADOR DE NIVEL<br>DICHTUNG / GASKET / JOINT / GUARNIZIONI / ANILLO<br>KUPFERRING / SEALING RING / JOINT / ANNELLO / ANILLO DE COBRE<br>ANSCHLUSSSCHRAUBE / CONNECTION SCREW / VIS DE RACCORDEMENT / VITE DI RACCORDO / TORNILLO DE EMPALME |
|  | U 4.70 SA/K - 54                          | 61<br>361   | X   | X   | 002405 26200   | ÖLABSCHEIDERGEHÄUSE / HOUSING FOR OIL SEPARATION / CARCASSE POUR SEPARATION D'HUILLE /<br>CARCASSA SEPARATORE OLIO / CARCASA SEPARADORA DE ACEITE  |

 standard

| optional<br>en option<br>optionale<br>opcional  | Variante(n)<br>Modifications<br>Variantes | Pos   |  |  | Bestell Nr.<br>Ident No.<br>No. Identification<br>No. Identificazione<br>No. De pedido   | Beschreibung / Description / Designation / Designazione / Descripcion  |
|--|---|---|---|---|--|--|
| <b>U 4.70 SA/XX</b><br><br><b>U 4.70 F/XX</b>  | U 4.70 SA<br>U 4.70 F                     | 135<br>141<br>144<br>156<br>157<br>158<br>159<br>160<br>192<br>193                                      | X   | X<br>X<br>X<br>X<br>X<br>X<br>X<br>X<br>X   | 012203 26200   | LEITUNG / PIPE / TUYAU / CONDOTTO / CONDUCTO   |
|  | U 4.70 SA/K - 25<br>U 4.70 F/K - 25       | 29<br>30<br>31<br>32<br>33<br>141<br>150<br>155<br>157<br>158<br>181<br>192<br>193<br>211<br>212<br>213 | X<br>X<br>X<br>X<br>X<br>X<br>X<br>X<br>X<br>X<br>X<br>X<br>X<br>X                | X<br>X<br>X<br>X<br>X<br>X<br>X<br>X<br>X<br>X<br>X<br>X<br>X<br>X<br>X           | 012214 26200<br>012213 26200<br>948420 00000<br>960204 26200<br>012212 26200<br>018301 26200<br><br>300000 02300<br>739213 01000<br>948024 00000 | LEITUNG / PIPE / TUYAU / CONDOTTO / CONDUCTO<br>LEITUNG / PIPE / TUYAU / CONDOTTO / CONDUCTO<br>HOHLSCHRAUBE / HOLLOW SCREW / VIS CREUSE / VITE ESAGONALE / TORNILLO HUECO<br>KUEHLER / COOLER / REFROIDISSEUR / RAFFREDDATORE / REFRIGERADOR<br>LEITUNG / PIPE / TUYAU / CONDOTTO / CONDUCTO<br>HAUBE / PROTECTING HOOD / CARTER PROTECTEUR / CARTER DI PROTEZIONE / SOMBRERETE<br><br>WINKEL / ELBOW / COUDES / GOMITO / ÁNGULO<br>SCHLAUCHSTUTZEN / HOSE CONNECTOR / CONNEXION TUYAU / ATTACCO TUBO / TUBULADURA DE MANGUERA<br>KUPFERRING / SEALING RING / JOINT / ANNELLO / ANILLO DE COBRE   |
|  | U 4.70 SA/K - 51<br>U 4.70 F/K - 51       | 61<br>65<br>341<br><br>342<br>343<br>344<br>345<br>346<br>347   | X<br><br>X<br>X<br>X<br>X<br>X<br>X   | X<br>X  | 002406 26200<br><br>960203 26200<br>943400 70000<br>741103 99682<br>948086 00000<br>948029 00000<br>912314 00000                                 | ÖLABSCHEIDERGEHÄUSE / HOUSING FOR OIL SEPARATION / CARCASSE POUR SEPARATION D'HUILLE /<br>CARCASSA SEPARATORE OLIO / CARCASA SEPARADORA DE ACEITE<br>ROHRHEIZKÖRPER / PIPE HEATER / CORPS DE CHAUFFE / SCALDIGLIA / CALEFACTOR TUBULAR<br>TEMPERATUR-WÄCHTER / THERMOSTAT / THERMOSTAT / INTERRUTTORE TERMICO / TERMOSTATO<br>NIVEAUGEBER / LEVEL TRANSMITTER / CAPTEUR DE NIVEAU / INDICATORE DI LIVELLO / CODIFICADOR DE NIVEL<br>DICHTUNG / GASKET / JOINT / GUARNIZIONI / ANILLO<br>KUPFERRING / SEALING RING / JOINT / ANNELLO / ANILLO DE COBRE<br>ANSCHLUSSSCHRAUBE / CONNECTION SCREW / VIS DE RACCORDEMENT / VITE DI RACCORDO / TORNILLO DE EMPALME |
|  | U 4.70 SA/K - 54                          | 61<br>361   | X   | X   | 002405 26200   | ÖLABSCHEIDERGEHÄUSE / HOUSING FOR OIL SEPARATION / CARCASSE POUR SEPARATION D'HUILLE /<br>CARCASSA SEPARATORE OLIO / CARCASA SEPARADORA DE ACEITE  |

 standard